

**Kayak Viticulture
Charlie Vineyard**
Vine Row Map
October 20, 2001

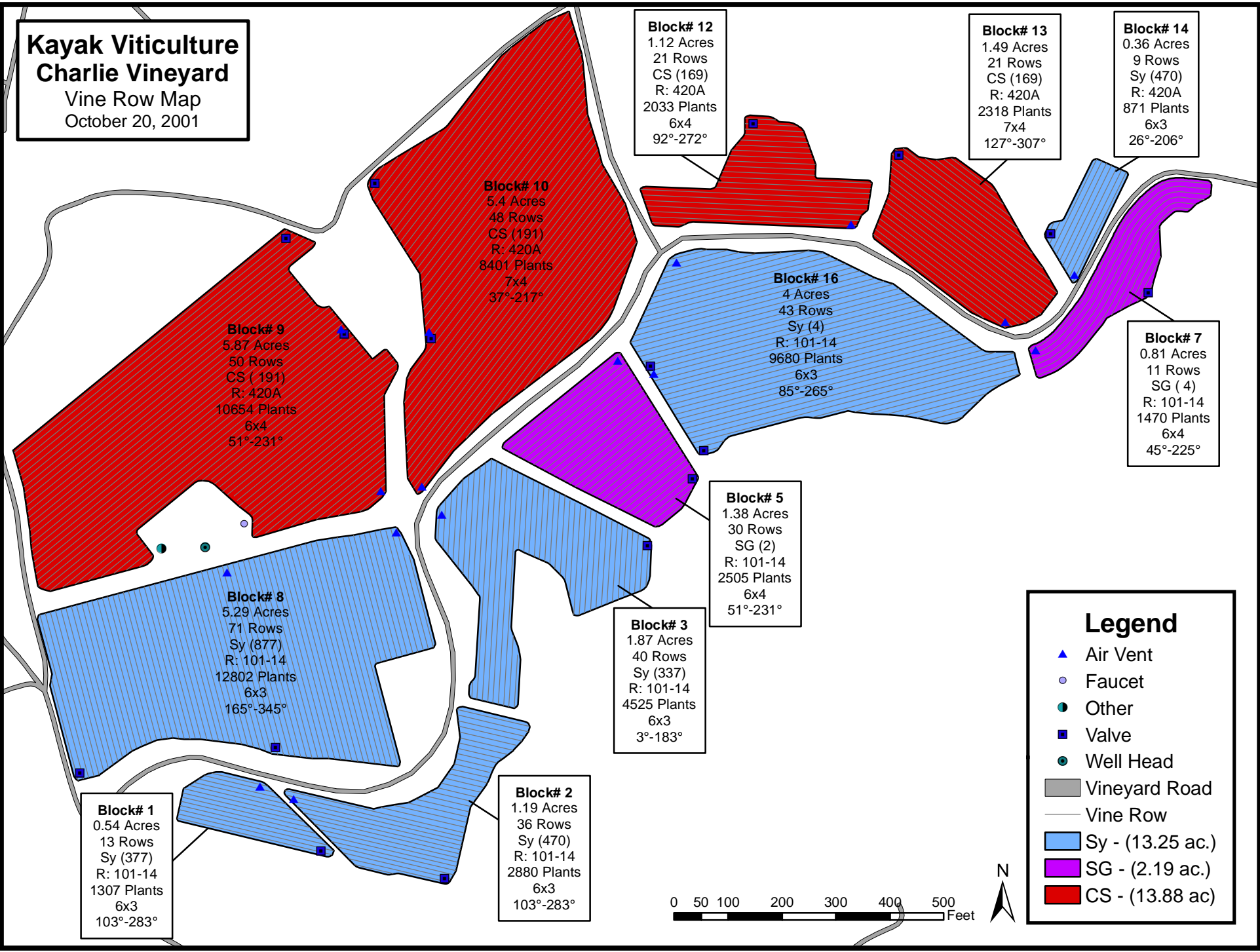

Block# 12
1.12 Acres
21 Rows
CS (169)
R: 420A
2033 Plants
6x4
92°-272°

Block# 13
1.49 Acres
21 Rows
CS (169)
R: 420A
2318 Plants
7x4
127°-307°

Block# 14
0.36 Acres
9 Rows
Sy (470)
R: 420A
871 Plants
6x3
26°-206°

Block# 10
5.4 Acres
48 Rows
CS (191)
R: 420A
8401 Plants
7x4
37°-217°

Block# 16
4 Acres
43 Rows
Sy (4)
R: 101-14
9680 Plants
6x3
85°-265°

Block# 7
0.81 Acres
11 Rows
SG (4)
R: 101-14
1470 Plants
6x4
45°-225°

Block# 9
5.87 Acres
50 Rows
CS (191)
R: 420A
10654 Plants
6x4
51°-231°

Block# 5
1.38 Acres
30 Rows
SG (2)
R: 101-14
2505 Plants
6x4
51°-231°

Block# 3
1.87 Acres
40 Rows
Sy (337)
R: 101-14
4525 Plants
6x3
3°-183°

Block# 8
5.29 Acres
71 Rows
Sy (877)
R: 101-14
12802 Plants
6x3
165°-345°

Block# 1
0.54 Acres
13 Rows
Sy (377)
R: 101-14
1307 Plants
6x3
103°-283°

Block# 2
1.19 Acres
36 Rows
Sy (470)
R: 101-14
2880 Plants
6x3
103°-283°

Legend

- ▲ Air Vent
- Faucet
- Other
- Valve
- Well Head
- ▬ Vineyard Road
- Vine Row
- Sy - (13.25 ac.)
- SG - (2.19 ac.)
- CS - (13.88 ac.)

